

General Information

Parcel Number 89-07-08-000-206.003-013
Local Parcel Number 08-08-000-206.030-08

Tax ID: 008-00337-06

Routing Number

Property Class 511
1 Family Dwell - Unplatted (0 to 9.9

Year: 2025

Location Information

County WAYNE

Township GREENE TOWNSHIP

District 013 (Local 008) GREENE TOWNSHIP

School Corp 8375 NORTHEASTERN WAYNE

Neighborhood 985073-008 GREENE-985073 (008)

Section/Plat 0808000

Location Address (1) 7766 US HIGHWAY 35 WILLIAMSBURG, IN 47393

Zoning ZO01 Residential

Subdivision

Lot

Market Model N/A

Characteristics

Topography Flood Hazard

Public Utilities ERA

Streets or Roads TIF Paved

Neighborhood Life Cycle Stage Static

Printed Tuesday, April 29, 2025

Review Group 2028

Ownership

MARCUM, BELVE JR & SUSAN A 7766 N US HIGHWAY 35 WILLIAMSBURG, IN 47393

Legal

LOT 2 KELSEY LANE ADDN REPLAT OF LOT 1



Transfer of Ownership

Table with columns: Date, Owner, Doc ID, Code, Book/Page, Adj Sale Price, V/I. Rows show transfer dates from 2008 to 2019.

Notes

6/22/2023 Misc: 2024 GENERAL REVALUATION
8/27/2020 Misc: 2021 GENERAL REVAL
3/10/2020 Misc: 2020: REMOVE OFF, CHANGE CONCP TO RFX/WDP PER ASSESSOR

Valuation Records (Work In Progress values are not certified values and are subject to change)

Table with columns: 2025, 2024, 2023, 2022, 2021. Rows include Assessment Year, Reason For Change, As Of Date, Valuation Method, Equalization Factor, Notice Required, Land, Improvement, Total, and various land/non-residential values.

Land Data (Standard Depth: Res 100', CI 100' Base Lot: Res 100' X 100', CI 100' X 100')

Table with columns: Land Type, Pricing Method, Soil ID, Act Front, Size, Factor, Rate, Adj. Rate, Ext. Value, Infl. %, Market Factor, Cap 1, Cap 2, Cap 3, Value. Rows 9, 91, 82.

Land Computations

Table with columns: Description, Value. Rows include Calculated Acreage (2.57), Actual Frontage (0), Developer Discount, Parcel Acreage (2.57), 81 Legal Drain NV (0.00), 82 Public Roads NV (0.07), 83 UT Towers NV (0.00), 9 Homesite (1.00), 91/92 Acres (1.50), Total Acres Farmland (0.00), Farmland Value (\$0), Measured Acreage (0.00), Avg Farmland Value/Acre (0.0), Value of Farmland (\$0), Classified Total (\$0), Farm / Classified Value (\$0), Homesite(s) Value (\$17,500), 91/92 Value (\$5,900), Supp. Page Land Value, CAP 1 Value (\$17,500), CAP 2 Value (\$5,900), CAP 3 Value (\$0), Total Value (\$23,400).

**General Information**

**Occupancy** Single-Family  
**Description** Residential Dwelling  
**Story Height** 1  
**Style** N/A  
**Finished Area** 1280 sqft  
**Make**

**Floor Finish**

Earth  Tile  
 Slab  Carpet  
 Sub & Joist  Unfinished  
 Wood  Other  
 Parquet

**Wall Finish**

Plaster/Drywall  Unfinished  
 Paneling  Other  
 Fiberboard

**Roofing**

Built-Up  Metal  Asphalt  Slate  Tile  
 Wood Shingle  Other

**Exterior Features**

| Description            | Area | Value   |
|------------------------|------|---------|
| Patio, Treated Pine    | 320  | \$2,200 |
| Canopy, Roof Extension | 320  | \$4,000 |
| Wood Deck              | 192  | \$4,600 |

**Plumbing**

|               | #        | TF       |
|---------------|----------|----------|
| Full Bath     | 1        | 3        |
| Half Bath     | 0        | 0        |
| Kitchen Sinks | 1        | 1        |
| Water Heaters | 1        | 1        |
| Add Fixtures  | 0        | 0        |
| <b>Total</b>  | <b>3</b> | <b>5</b> |

**Accommodations**

|                    |          |
|--------------------|----------|
| Bedrooms           | 3        |
| Living Rooms       | 1        |
| Dining Rooms       | 0        |
| Family Rooms       | 0        |
| <b>Total Rooms</b> | <b>5</b> |

**Heat Type**

Central Warm Air

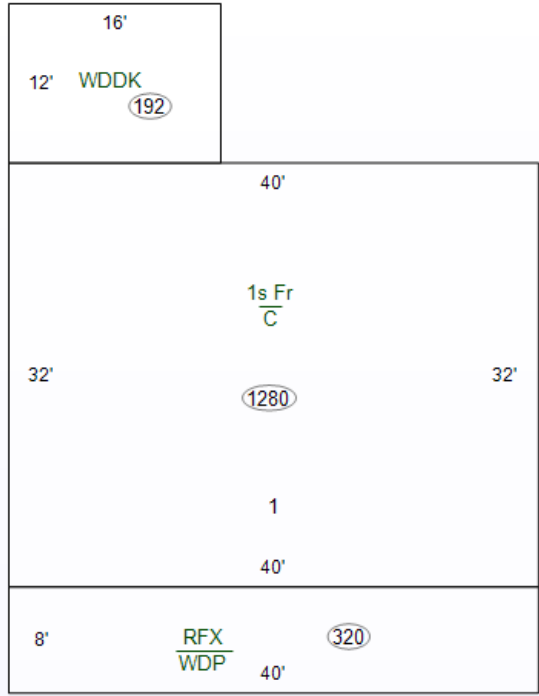

**Specialty Plumbing**

| Description | Count | Value |
|-------------|-------|-------|
|-------------|-------|-------|

**Cost Ladder**

| Floor Constr | Base | Finish | Value     | Totals |
|--------------|------|--------|-----------|--------|
| 1 1Fr        | 1280 | 1280   | \$122,700 |        |
| 2            |      |        |           |        |
| 3            |      |        |           |        |
| 4            |      |        |           |        |
| 1/4          |      |        |           |        |
| 1/2          |      |        |           |        |
| 3/4          |      |        |           |        |
| Attic        |      |        |           |        |
| Bsmt         |      |        |           |        |
| Crawl        | 1280 | 0      | \$8,700   |        |
| Slab         |      |        |           |        |

**Total Base** \$131,400

**Adjustments** 1 Row Type Adj. x 1.00 \$131,400

|                  |                     |
|------------------|---------------------|
| Unfin Int (-)    | \$0                 |
| Ex Liv Units (+) | \$0                 |
| Rec Room (+)     | \$0                 |
| Loft (+)         | \$0                 |
| Fireplace (+)    | \$0                 |
| No Heating (-)   | \$0                 |
| A/C (+)          | 1:1280 \$4,400      |
| No Elec (-)      | \$0                 |
| Plumbing (+ / -) | 5 - 5 = 0 x \$0 \$0 |
| Spec Plumb (+)   | \$0                 |
| Elevator (+)     | \$0                 |

**Sub-Total, One Unit** \$135,800

**Sub-Total, 1 Units**

|                                   |          |           |
|-----------------------------------|----------|-----------|
| Exterior Features (+)             | \$10,800 | \$146,600 |
| Garages (+) 0 sqft                | \$0      | \$146,600 |
| Quality and Design Factor (Grade) |          | 1.00      |
| Location Multiplier               |          | 0.85      |

**Replacement Cost** \$124,610

**Summary of Improvements**

| Description               | Story Height | Constr Type | Grade | Year Built | Eff Year | Eff Co Age | nd | Base Rate | LCM  | Adj Rate | Size       | RCN       | Norm Dep | Remain. Value | Abn Obs | PC   | Nbhd  | Mrkt  | Cap 1  | Cap 2 | Cap 3 | Improv Value |
|---------------------------|--------------|-------------|-------|------------|----------|------------|----|-----------|------|----------|------------|-----------|----------|---------------|---------|------|-------|-------|--------|-------|-------|--------------|
| 1: Residential Dwelling   | 1            | Wood Fr     | C     | 2000       | 2000     | 25         | A  |           | 0.85 |          | 1,280 sqft | \$124,610 | 22%      | \$97,200      | 0%      | 100% | 1.190 | 1.000 | 100.00 | 0.00  | 0.00  | \$115,700    |
| 2: Detached Garage/Boat H | 1            | Wood Fr     | C     | 2011       | 2011     | 14         | A  | \$33.17   | 0.85 | \$28.19  | 30'x40'    | \$33,833  | 13%      | \$29,440      | 0%      | 100% | 1.190 | 1.000 | 100.00 | 0.00  | 0.00  | \$35,000     |
| 3: Utility Shed           | 1            | SV          | D     | 2002       | 2002     | 23         | A  |           | 0.85 |          | 10'x16'    |           | 55%      |               | 0%      | 100% | 1.190 | 1.000 | 100.00 | 0.00  | 0.00  | \$0          |