

General Information

Parcel Number 89-07-16-200-213.000-013
Local Parcel Number 08-16-200-213.000-08

Tax ID: 008-00250-00

Routing Number

Property Class 511
1 Family Dwell - Unplatted (0 to 9.9

Year: 2025

Location Information

County WAYNE

Township GREENE TOWNSHIP

District 013 (Local 008) GREENE TOWNSHIP

School Corp 8375 NORTHEASTERN WAYNE

Neighborhood 985073-008 GREENE-985073 (008)

Section/Plat 0816200

Location Address (1) 4684 HELM RD WILLIAMSBURG, IN 47393

Zoning ZO01 Residential

Subdivision

Lot

Market Model N/A

Characteristics

Topography Level Flood Hazard

Public Utilities Electricity ERA

Streets or Roads Paved TIF

Neighborhood Life Cycle Stage Static

Printed Tuesday, April 29, 2025

Review Group 2028

Ownership

FRANK, LEO A & PENELOPE D
4684 HELM RD
WILLIAMSBURG, IN 47393

Legal

PT NE SEC 16-17-14 1.0A



Transfer of Ownership

Date 01/01/1900 Owner FRANK, LEO A & PEN Doc ID Code Book/Page Adj Sale Price V/I

Notes

6/29/2023 Misc: 2024 GENERAL REVALUATION
8/14/2020 Misc: 2021 GENERAL REVAL

Valuation Records (Work In Progress values are not certified values and are subject to change)

Table with columns for Assessment Year (2025-2022), Reason For Change, As Of Date, Valuation Method, Equalization Factor, Notice Required, and Land/Improvement values.

Land Data (Standard Depth: Res 100', CI 100' Base Lot: Res 100' X 100', CI 100' X 100')

Table with columns for Land Type, Pricing Method, Soil ID, Act Front, Size, Factor, Rate, Adj. Rate, Ext. Value, Infl. %, Market Factor, Cap 1, Cap 2, Cap 3, and Value.

Land Computations

Table with columns for various land metrics like Calculated Acreage, Actual Frontage, Developer Discount, Parcel Acreage, etc., and their values.

**General Information**

**Occupancy** Single-Family  
**Description** Residential Dwelling  
**Story Height** 1  
**Style** N/A  
**Finished Area** 1425 sqft  
**Make**

**Floor Finish**

- Earth
- Slab
- Sub & Joist
- Wood
- Parquet
- Tile
- Carpet
- Unfinished
- Other

**Wall Finish**

- Plaster/Drywall
- Paneling
- Fiberboard
- Unfinished
- Other

**Roofing**

- Built-Up
- Wood Shingle
- Metal
- Asphalt
- Other
- Slate
- Tile

**Exterior Features**

| Description       | Area | Value   |
|-------------------|------|---------|
| Patio, Concrete   | 96   | \$800   |
| Porch, Open Frame | 60   | \$4,300 |

**Plumbing**

|                      | # | TF |
|----------------------|---|----|
| <b>Full Bath</b>     | 2 | 6  |
| <b>Half Bath</b>     | 0 | 0  |
| <b>Kitchen Sinks</b> | 1 | 1  |
| <b>Water Heaters</b> | 1 | 1  |
| <b>Add Fixtures</b>  | 0 | 0  |
| <b>Total</b>         | 4 | 8  |

**Accommodations**

|                     |   |
|---------------------|---|
| <b>Bedrooms</b>     | 3 |
| <b>Living Rooms</b> | 1 |
| <b>Dining Rooms</b> | 0 |
| <b>Family Rooms</b> | 0 |
| <b>Total Rooms</b>  | 6 |

**Heat Type**

Central Warm Air

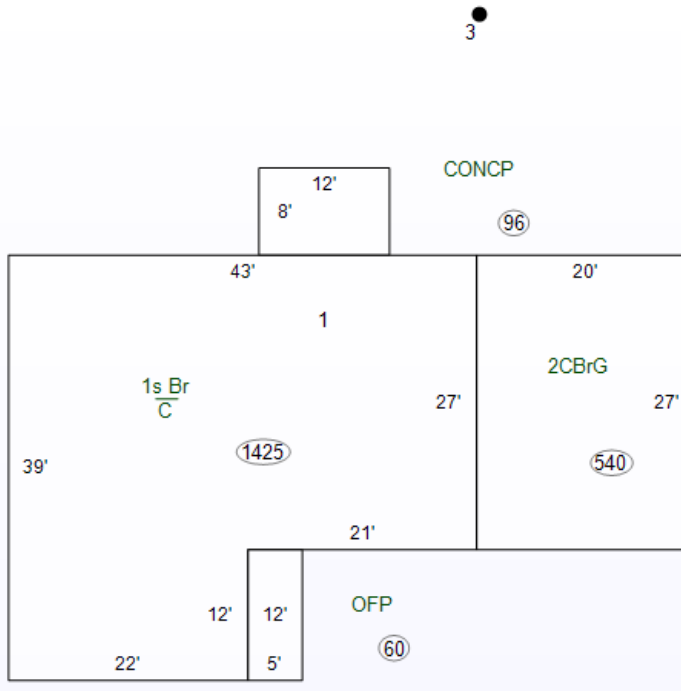

**Specialty Plumbing**

| Description | Count | Value |
|-------------|-------|-------|
|-------------|-------|-------|

**Cost Ladder**

| Floor | Constr | Base | Finish | Value     | Totals |
|-------|--------|------|--------|-----------|--------|
| 1     | 7      | 1425 | 1425   | \$143,700 |        |
| 2     |        |      |        |           |        |
| 3     |        |      |        |           |        |
| 4     |        |      |        |           |        |
| 1/4   |        |      |        |           |        |
| 1/2   |        |      |        |           |        |
| 3/4   |        |      |        |           |        |
| Attic |        |      |        |           |        |
| Bsmt  |        |      |        |           |        |
| Crawl |        | 1425 | 0      | \$9,100   |        |
| Slab  |        |      |        |           |        |

**Total Base** \$152,800

**Adjustments** 1 Row Type Adj. x 1.00 \$152,800

|                  |                             |
|------------------|-----------------------------|
| Unfin Int (-)    | \$0                         |
| Ex Liv Units (+) | \$0                         |
| Rec Room (+)     | \$0                         |
| Loft (+)         | \$0                         |
| Fireplace (+)    | \$0                         |
| No Heating (-)   | \$0                         |
| A/C (+)          | \$0                         |
| No Elec (-)      | \$0                         |
| Plumbing (+ / -) | 8 - 5 = 3 x \$800 = \$2,400 |
| Spec Plumb (+)   | \$0                         |
| Elevator (+)     | \$0                         |

**Sub-Total, One Unit** \$155,200

**Sub-Total, 1 Units**

|                                   |          |           |
|-----------------------------------|----------|-----------|
| Exterior Features (+)             | \$5,100  | \$160,300 |
| Garages (+) 540 sqft              | \$22,300 | \$182,600 |
| Quality and Design Factor (Grade) | 1.00     |           |
| Location Multiplier               | 0.85     |           |

**Replacement Cost** \$155,210

**Summary of Improvements**

| Description             | Story Height | Constr Type | Grade | Year Built | Eff Year | Eff Co Age | nd | Base Rate | LCM  | Adj Rate | Size       | RCN       | Norm Dep | Remain. Value | Abn Obs | PC   | Nbhd  | Mrkt  | Cap 1  | Cap 2 | Cap 3 | Improv Value |
|-------------------------|--------------|-------------|-------|------------|----------|------------|----|-----------|------|----------|------------|-----------|----------|---------------|---------|------|-------|-------|--------|-------|-------|--------------|
| 1: Residential Dwelling | 1            | Brick       | C     | 1969       | 1969     | 56         | A  |           | 0.85 |          | 1,425 sqft | \$155,210 | 40%      | \$93,130      | 0%      | 100% | 1.190 | 1.000 | 100.00 | 0.00  | 0.00  | \$110,800    |
| 2: Utility Shed         | 1            |             | D     | 2001       | 2001     | 24         | A  | \$20.44   | 0.85 | \$13.90  | 12'x16'    | \$2,669   | 55%      | \$1,200       | 0%      | 100% | 1.190 | 1.000 | 100.00 | 0.00  | 0.00  | \$1,400      |
| 3: Utility Shed         | 1            | SV          | C     | 2000       | 2000     | 25         | A  |           | 0.85 |          | 10'x12'    |           | 55%      |               | 0%      | 100% | 1.190 | 1.000 | 100.00 | 0.00  | 0.00  | \$0          |