

General Information

Parcel Number 89-08-26-130-115.000-016
Local Parcel Number 24-26-130-115.000-19

Tax ID: 019-01710-00

Routing Number

Property Class 510
1 Family Dwell - Platted Lot

Year: 2025

Location Information

County WAYNE

Township JACKSON TOWNSHIP

District 016 (Local 019)
CAMBRIDGE CITY TOWN

School Corp 8355
WESTERN WAYNE

Neighborhood 194087-019
JACKSON-194087 (019)

Section/Plat 2426130

Location Address (1)
709 E MAIN ST
CAMBRIDGE CITY, IN 47327

Zoning ZO01 Residential

Subdivision

Lot

Market Model N/A

Characteristics

Topography Level Flood Hazard

Public Utilities All ERA

Streets or Roads Paved TIF

Neighborhood Life Cycle Stage Static

Printed Tuesday, April 29, 2025

Review Group 2028

Ownership

MAYBERRY, CYNTHIA A
709 E MAIN ST
CAMBRIDGE CITY, IN 47327

Legal

ERNR LOT 28 OP



Transfer of Ownership

Table with columns: Date, Owner, Doc ID, Code, Book/Page, Adj Sale Price, V/I. Rows include transactions from 2021 and 2019.

Notes

12/11/2023 Misc: 2024 GENERAL REVAL

Valuation Records (Work In Progress values are not certified values and are subject to change)

Table with columns: Year, Assessment Year, Reason For Change, As Of Date, Valuation Method, Equalization Factor, Notice Required, Land, Improvement, Total. Rows show values for years 2025, 2024, 2023, 2022, 2021.

Land Data (Standard Depth: Res 132', CI 132' Base Lot: Res 100' X 132', CI 100' X 132')

Table with columns: Land Type, Pricing Method, Soil ID, Act Front, Size, Factor, Rate, Adj. Rate, Ext. Value, Infl. %, Market Factor, Cap 1, Cap 2, Cap 3, Value.

Land Computations

Table with columns: Computation Name, Value. Rows include Calculated Acreage, Actual Frontage, Developer Discount, Parcel Acreage, 81 Legal Drain NV, 82 Public Roads NV, 83 UT Towers NV, 9 Homesite, 91/92 Acres, Total Acres Farmland, Farmland Value, Measured Acreage, Avg Farmland Value/Acre, Value of Farmland, Classified Total, Farm / Classified Value, Homesite(s) Value, 91/92 Value, Supp. Page Land Value, CAP 1 Value, CAP 2 Value, CAP 3 Value, Total Value.

General Information

Occupancy Single-Family
Description Residential Dwelling
Story Height 1
Style N/A
Finished Area 1904 sqft
Make

Floor Finish

Earth Tile
 Slab Carpet
 Sub & Joist Unfinished
 Wood Other
 Parquet

Wall Finish

Plaster/Drywall Unfinished
 Paneling Other
 Fiberboard

Roofing

Built-Up Metal Asphalt Slate Tile
 Wood Shingle Other

Exterior Features

Description	Area	Value
Wood Deck	352	\$7,100
Porch, Open Frame	112	\$6,300
Porch, Open Frame	224	\$10,900

Plumbing

	#	TF
Full Bath	1	3
Half Bath	0	0
Kitchen Sinks	1	1
Water Heaters	1	1
Add Fixtures	0	0
Total	3	5

Accommodations

Bedrooms	4
Living Rooms	1
Dining Rooms	0
Family Rooms	0
Total Rooms	7

Heat Type

Central Warm Air

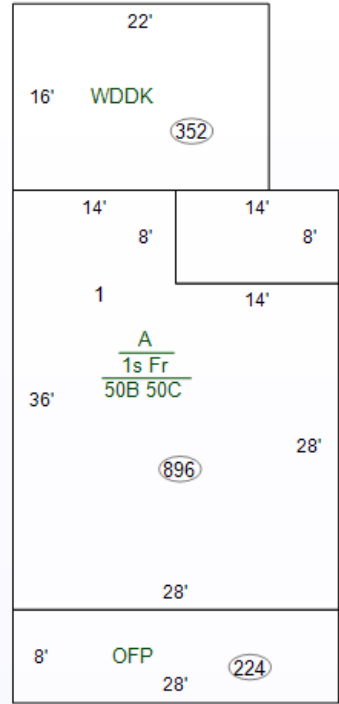

A
OFF
112

Specialty Plumbing

Description	Count	Value
-------------	-------	-------

Cost Ladder

Floor	Constr	Base	Finish	Value	Totals
1	1Fr	896	896	\$96,900	
2					
3					
4					
1/4					
1/2					
3/4					
Attic		1008	1008	\$22,200	
Bsmt		448	0	\$22,800	
Crawl		448	0	\$5,400	
Slab					

Total Base \$147,300

Adjustments 1 Row Type Adj. x 1.00 \$147,300

Unfin Int (-)	\$0
Ex Liv Units (+)	\$0
Rec Room (+)	\$0
Loft (+)	\$0
Fireplace (+)	\$0
No Heating (-)	\$0
A/C (+)	1:896 A:1008 \$5,200
No Elec (-)	\$0
Plumbing (+ / -)	5 - 5 = 0 x \$0 \$0
Spec Plumb (+)	\$0
Elevator (+)	\$0

Sub-Total, One Unit \$152,500

Sub-Total, 1 Units

Exterior Features (+)	\$24,300	\$176,800
Garages (+) 0 sqft	\$0	\$176,800
Quality and Design Factor (Grade)		0.90
Location Multiplier		0.85
Replacement Cost		\$135,252

Summary of Improvements

Description	Story Height	Constr Type	Grade	Year Built	Eff Year	Eff Age	Co Age	nd	Base Rate	LCM	Adj Rate	Size	RCN	Norm Dep	Remain. Value	Abn Obs	PC	Nbhd	Mrkt	Cap 1	Cap 2	Cap 3	Improv Value
1: Residential Dwelling	1	Wood Fr	D+2	1920	1970	55	A			0.85		2,352 sqft	\$135,252	45%	\$74,390	0%	100%	1.090	1.000	100.00	0.00	0.00	\$81,100