

89-17-01-210-205.000-030

MILLER, CHARLOTTE

2501 W MAIN ST

510, 1 Family Dwell - Platted Lot

WAYNE-294416 (029)/2944

1/2

General Information

Parcel Number 89-17-01-210-205.000-030
Local Parcel Number 49-01-210-205.000-29

Tax ID: 029-30829-00

Routing Number

Property Class 510
1 Family Dwell - Platted Lot

Year: 2025

Location Information

County WAYNE
Township WAYNE TOWNSHIP
District 030 (Local 029) RICHMOND CITY -WAYNE TWP
School Corp 8385 RICHMOND COMMUNITY
Neighborhood 294416-029 WAYNE-294416 (029)
Section/Plat 4901210
Location Address (1) 2501 W MAIN ST RICHMOND, IN 47374

Zoning ZO01 Residential

Subdivision

Lot

Market Model N/A

Characteristics

Topography Level Flood Hazard
Public Utilities All ERA
Streets or Roads Paved TIF

Neighborhood Life Cycle Stage Static

Printed Tuesday, April 29, 2025
Review Group 2028

Ownership

MILLER, CHARLOTTE
2501 W MAIN ST
RICHMOND, IN 47374

Legal

LOT 57 RICHWOOD SECTION 2

Transfer of Ownership

Table with columns: Date, Owner, Doc ID, Code, Book/Page, Adj Sale Price, V/I. Rows include transactions from 07/24/2020 to 01/01/1900.

Notes

9/14/2023 Misc: 2024 GENERAL REVALUATION
10/10/2019 Misc: 2021 SALES REVIEW 2020 GENERAL REVALUATION



Res

Valuation Records (Work In Progress values are not certified values and are subject to change)

Table with columns: Assessment Year, Reason For Change, As Of Date, Valuation Method, Equalization Factor, Notice Required, Land, Land Res (1), Land Non Res (2), Land Non Res (3), Improvement, Imp Res (1), Imp Non Res (2), Imp Non Res (3), Total, Total Res (1), Total Non Res (2), Total Non Res (3). Rows show values for years 2025, 2024, 2023, 2022, 2021.

Land Data (Standard Depth: Res 150', CI 150' Base Lot: Res 100' X 150', CI 100' X 150')

Table with columns: Land Type, Pricing Method, Soil ID, Act Front, Size, Factor, Rate, Adj. Rate, Ext. Value, Infl. %, Market Factor, Cap 1, Cap 2, Cap 3, Value. Row shows values for F, F, 70, 70x120, 0.90, \$322, \$290, \$20,300, 0%, 1.0000, 100.00, 0.00, 0.00, \$20,300.

Land Computations

Table with columns: Computation Name, Value. Rows include Calculated Acreage (0.19), Actual Frontage (70), Developer Discount, Parcel Acreage (0.19), 81 Legal Drain NV (0.00), 82 Public Roads NV (0.00), 83 UT Towers NV (0.00), 9 Homesite (0.00), 91/92 Acres (0.00), Total Acres Farmland (0.19), Farmland Value (\$0), Measured Acreage (0.00), Avg Farmland Value/Acre (0.0), Value of Farmland (\$0), Classified Total (\$0), Farm / Classified Value (\$0), Homesite(s) Value (\$0), 91/92 Value (\$0), Supp. Page Land Value, CAP 1 Value (\$20,300), CAP 2 Value (\$0), CAP 3 Value (\$0), Total Value (\$20,300).

General Information

Occupancy Single-Family
Description Residential Dwelling
Story Height 1
Style N/A
Finished Area 1432 sqft
Make

Floor Finish

- Earth Tile
- Slab Carpet
- Sub & Joist Unfinished
- Wood Other
- Parquet

Wall Finish

- Plaster/Drywall Unfinished
- Paneling Other
- Fiberboard

Roofing

- Built-Up Metal Asphalt Slate Tile
- Wood Shingle Other

Exterior Features

Description	Area	Value
Patio, Concrete	120	\$1,000

Plumbing

	#	TF
Full Bath	2	6
Half Bath	0	0
Kitchen Sinks	1	1
Water Heaters	1	1
Add Fixtures	0	0
Total	4	8

Accommodations

Bedrooms	3
Living Rooms	1
Dining Rooms	0
Family Rooms	0
Total Rooms	6

Heat Type

Central Warm Air

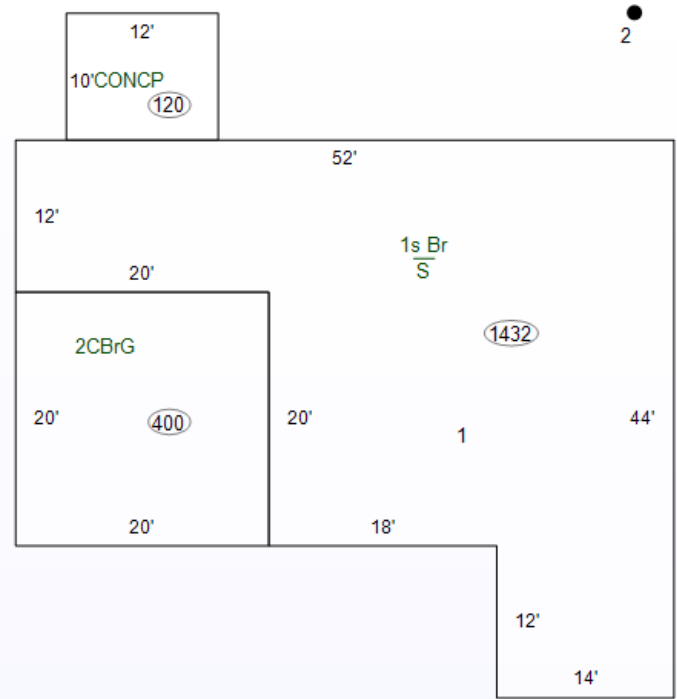

Specialty Plumbing

Description	Count	Value
-------------	-------	-------

Cost Ladder

Floor Constr	Base	Finish	Value	Totals
1 7	1432	1432	\$143,700	
2				
3				
4				
1/4				
1/2				
3/4				
Attic				
Bsmt				
Crawl				
Slab	1432	0	\$0	
Total Base			\$143,700	

Adjustments 1 Row Type Adj. x 1.00 \$143,700

Unfin Int (-)	\$0
Ex Liv Units (+)	\$0
Rec Room (+)	\$0
Loft (+)	\$0
Fireplace (+)	\$0
No Heating (-)	\$0
A/C (+)	1:1432 \$4,600
No Elec (-)	\$0
Plumbing (+ / -)	8 - 5 = 3 x \$800 \$2,400
Spec Plumb (+)	\$0
Elevator (+)	\$0
Sub-Total, One Unit \$150,700	

Sub-Total, 1 Units

Exterior Features (+)	\$1,000	\$151,700
Garages (+) 400 sqft	\$17,800	\$169,500
Quality and Design Factor (Grade)	1.05	
Location Multiplier	0.85	
Replacement Cost		\$151,279

Summary of Improvements

Description	Story Height	Constr Type	Grade	Year Built	Eff Year	Eff Co Age nd	Base Rate	LCM	Adj Rate	Size	RCN	Norm Dep	Remain. Value	Abn Obs	PC	Nbhd	Mrkt	Cap 1	Cap 2	Cap 3	Improv Value
1: Residential Dwelling	1	Brick	C+1	1963	1983	42 A		0.85		1,432 sqft	\$151,279	30%	\$105,900	0%	100%	1.270	1.000	100.00	0.00	0.00	\$134,500
2: Utility Shed	1	SV	D	2000	2000	25 A		0.85		6'x16'		55%		0%	100%	1.270	1.000	100.00	0.00	0.00	\$0