

89-18-03-110-309.000-030

ROSENBERG, DANIEL & PRUDE

201 S 23RD ST

511, 1 Family Dwell - Unplatted (0 to 9.9

WAYNE-294337 (029)/2943

1/2

General Information

Parcel Number 89-18-03-110-309.000-030
Local Parcel Number 50-03-110-309.000-29

Tax ID: 029-30226-00

Routing Number 5003110-001

Property Class 511
1 Family Dwell - Unplatted (0 to 9.9

Year: 2025

Location Information

County WAYNE
Township WAYNE TOWNSHIP
District 030 (Local 029) RICHMOND CITY -WAYNE TWP
School Corp 8385 RICHMOND COMMUNITY
Neighborhood 294337-029 WAYNE-294337 (029)
Section/Plat 5003110
Location Address (1) 201 S 23RD ST RICHMOND, IN 47374

Zoning ZO01 Residential

Subdivision

Lot

Market Model N/A

Characteristics

Topography Level Flood Hazard
Public Utilities All ERA
Streets or Roads Paved TIF

Neighborhood Life Cycle Stage Static

Printed Tuesday, April 29, 2025
Review Group 2029

Ownership

ROSENBERG, DANIEL & PRUDENCE
201 S 23RD ST
RICHMOND, IN 47374

Legal

PT NW SEC 3-13-1 175.28 X 236 FT



Transfer of Ownership

Date 01/01/1900 Owner ROSENBERG, DANIE
Doc ID Code Book/Page Adj Sale Price V/I

Notes

8/26/2024 Misc: 2025 GENERAL REVALUATION
10/12/2018 Misc: 2019 GENERAL REVALUATION

Valuation Records (Work In Progress values are not certified values and are subject to change)

Table with columns for Assessment Year (2022-2025), Reason For Change, As Of Date, Valuation Method, Equalization Factor, Notice Required, and Land/Improvement values.

Land Data (Standard Depth: Res 200', CI 200' Base Lot: Res 100' X 200', CI 100' X 200')

Table with columns for Land Type, Pricing Method, Soil ID, Act Front, Size, Factor, Rate, Adj. Rate, Ext. Value, Infl. %, Market Factor, Cap 1, Cap 2, Cap 3, and Value.

Land Computations

Table with columns for various land metrics such as Calculated Acreage, Actual Frontage, Developer Discount, Parcel Acreage, and Total Value.

General Information

| | |
|----------------------|----------------------|
| Occupancy | Single-Family |
| Description | Residential Dwelling |
| Story Height | 2 |
| Style | N/A |
| Finished Area | 2599 sqft |
| Make | |

Floor Finish

| | |
|---|--|
| <input type="checkbox"/> Earth | <input type="checkbox"/> Tile |
| <input checked="" type="checkbox"/> Slab | <input checked="" type="checkbox"/> Carpet |
| <input checked="" type="checkbox"/> Sub & Joist | <input checked="" type="checkbox"/> Unfinished |
| <input type="checkbox"/> Wood | <input type="checkbox"/> Other |
| <input type="checkbox"/> Parquet | |

Wall Finish

| | |
|---|--|
| <input checked="" type="checkbox"/> Plaster/Drywall | <input checked="" type="checkbox"/> Unfinished |
| <input type="checkbox"/> Paneling | <input type="checkbox"/> Other |
| <input type="checkbox"/> Fiberboard | |

Roofing

| | | | | |
|---------------------------------------|--------------------------------|---|--------------------------------|-------------------------------|
| <input type="checkbox"/> Built-Up | <input type="checkbox"/> Metal | <input checked="" type="checkbox"/> Asphalt | <input type="checkbox"/> Slate | <input type="checkbox"/> Tile |
| <input type="checkbox"/> Wood Shingle | | <input type="checkbox"/> Other | | |

Exterior Features

| Description | Area | Value |
|-----------------------|------|----------|
| Stoop, Masonry | 30 | \$1,800 |
| Wood Deck | 522 | \$9,600 |
| Porch, Enclosed Frame | 112 | \$9,400 |
| Porch, Open Frame | 434 | \$17,200 |

Plumbing

| | # | TF |
|----------------------|---|----|
| Full Bath | 2 | 6 |
| Half Bath | 1 | 2 |
| Kitchen Sinks | 1 | 1 |
| Water Heaters | 1 | 1 |
| Add Fixtures | 0 | 0 |
| Total | 5 | 10 |

Accommodations

| | |
|---------------------|---|
| Bedrooms | 4 |
| Living Rooms | 1 |
| Dining Rooms | 1 |
| Family Rooms | 1 |
| Total Rooms | 8 |

Heat Type

Central Warm Air

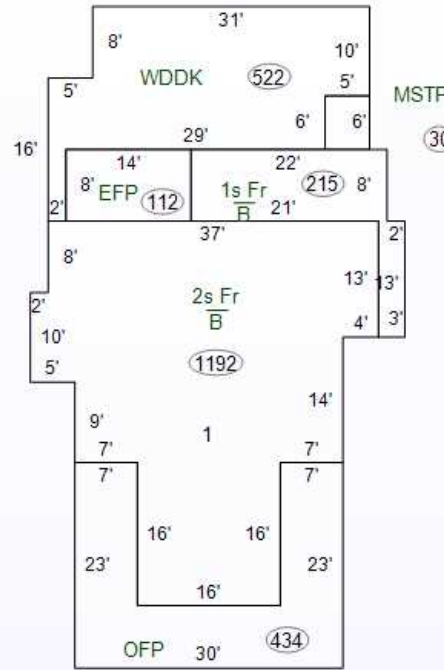

| Description | Count | Value |
|--------------------|-------|-------|
| Specialty Plumbing | | |

Cost Ladder

| Floor | Constr | Base | Finish | Value | Totals |
|-------|--------|------|--------|-----------|--------|
| 1 | 1Fr | 1407 | 1407 | \$129,100 | |
| 2 | 1Fr | 1192 | 1192 | \$58,600 | |
| 3 | | | | | |
| 4 | | | | | |
| 1/4 | | | | | |
| 1/2 | | | | | |
| 3/4 | | | | | |
| Attic | | | | | |
| Bsmt | | 1407 | 0 | \$43,200 | |
| Crawl | | | | | |
| Slab | | | | | |

| | |
|--------------------|-------------------------------|
| Total Base | \$230,900 |
| Adjustments | 1 Row Type Adj. x 1.00 |
| Adjustments | \$230,900 |

| | |
|------------------|----------------------------|
| Unfin Int (-) | \$0 |
| Ex Liv Units (+) | \$0 |
| Rec Room (+) | \$0 |
| Loft (+) | \$0 |
| Fireplace (+) | MS:1 MO:1 \$4,500 |
| No Heating (-) | \$0 |
| A/C (+) | 2:1192 1:1407 \$7,000 |
| No Elec (-) | \$0 |
| Plumbing (+ / -) | 10 - 5 = 5 x \$800 \$4,000 |
| Spec Plumb (+) | \$0 |
| Elevator (+) | \$0 |

| | |
|----------------------------|-----------|
| Sub-Total, One Unit | \$246,400 |
|----------------------------|-----------|

| | |
|---------------------------|-----------|
| Sub-Total, 1 Units | \$246,400 |
|---------------------------|-----------|

| | | |
|-----------------------|----------|-----------|
| Exterior Features (+) | \$38,000 | \$284,400 |
|-----------------------|----------|-----------|

| | | |
|--------------------|-----|-----------|
| Garages (+) 0 sqft | \$0 | \$284,400 |
|--------------------|-----|-----------|

| | |
|-----------------------------------|------|
| Quality and Design Factor (Grade) | 1.00 |
|-----------------------------------|------|

| | |
|---------------------|------|
| Location Multiplier | 0.85 |
|---------------------|------|

| | |
|-------------------------|-----------|
| Replacement Cost | \$241,740 |
|-------------------------|-----------|

Summary of Improvements

| Description | Story Height | Constr Type | Grade | Year Built | Eff Year | Eff Co Age nd | Base Rate | LCM | Adj Rate | Size | RCN | Norm Dep | Remain. Value | Abn Obs | PC | Nbhd | Mrkt | Cap 1 | Cap 2 | Cap 3 | Improv Value |
|---------------------------|--------------|-------------|-------|------------|----------|---------------|-----------|------|----------|------------|-----------|----------|---------------|---------|------|-------|-------|--------|-------|-------|--------------|
| 1: Residential Dwelling | 2 | Wood Fr | C | 1920 | 1920 | 105 F | | 0.85 | | 4,006 sqft | \$241,740 | 50% | \$120,870 | 34% | 100% | 1.260 | 1.000 | 100.00 | 0.00 | 0.00 | \$100,500 |
| 2: Detached Garage/Boat H | 1 | Wood Fr | C | 1971 | 1971 | 54 A | \$42.58 | 0.85 | \$40.41 | 22'x24' | \$21,336 | 40% | \$12,800 | 0% | 100% | 1.260 | 1.000 | 100.00 | 0.00 | 0.00 | \$16,100 |