

General Information

Parcel Number 89-18-03-140-604.000-030
Local Parcel Number 50-03-140-604.000-29

Tax ID: 029-08063-00

Routing Number 5003140-029

Property Class 510
1 Family Dwell - Platted Lot

Year: 2025

Location Information

County WAYNE

Township WAYNE TOWNSHIP

District 030 (Local 029)
RICHMOND CITY -WAYNE TWP

School Corp 8385
RICHMOND COMMUNITY

Neighborhood 294383-029
WAYNE-294383 (029)

Section/Plat 5003140

Location Address (1)
2821 REEVESTON RD
RICHMOND, IN 47374

Zoning

Subdivision

Lot

Market Model
N/A

Characteristics

Topography Level Flood Hazard

Public Utilities All ERA

Streets or Roads Paved TIF

Neighborhood Life Cycle Stage
Static

Printed Tuesday, April 29, 2025

Review Group 2029

Ownership

JUDY, CAROL ANN
2821 REEVESTON RD
RICHMOND, IN 47374

Legal

LOT 24 ARTHUR M CHARLES 2ND ADDN

Transfer of Ownership

Table with columns: Date, Owner, Doc ID, Code, Book/Page, Adj Sale Price, V/I. Rows include transfers from 04/02/2012 to 01/01/1900.

Notes

10/31/2018 Misc: 2019 GENERAL REVALUATION - ADD CONCP



Res

Valuation Records (Work In Progress values are not certified values and are subject to change)

Table with columns: 2025, 2024, 2023, 2022, 2021. Rows include Assessment Year, Reason For Change, As Of Date, Valuation Method, Equalization Factor, Notice Required, Land, Improvement, Total, and various Res categories.

Land Data (Standard Depth: Res 132', CI 132' Base Lot: Res 100' X 132', CI 100' X 132')

Table with columns: Land Type, Pricing Method, Soil ID, Act Front, Size, Factor, Rate, Adj. Rate, Ext. Value, Infl. %, Market Factor, Cap 1, Cap 2, Cap 3, Value.

Land Computations

Table with columns: Computation Name, Value. Rows include Calculated Acreage (0.31), Actual Frontage (95), Developer Discount, Parcel Acreage (0.31), 81 Legal Drain NV (0.00), 82 Public Roads NV (0.00), 83 UT Towers NV (0.00), 9 Homesite (0.00), 91/92 Acres (0.00), Total Acres Farmland (0.31), Farmland Value (\$0), Measured Acreage (0.00), Avg Farmland Value/Acre (0.0), Value of Farmland (\$0), Classified Total (\$0), Farm / Classified Value (\$0), Homesite(s) Value (\$0), 91/92 Value (\$0), Supp. Page Land Value, CAP 1 Value (\$26,900), CAP 2 Value (\$0), CAP 3 Value (\$0), Total Value (\$26,900).

General Information

Occupancy	Single-Family
Description	Residential Dwelling
Story Height	1
Style	N/A
Finished Area	1568 sqft
Make	

Floor Finish

<input type="checkbox"/> Earth	<input type="checkbox"/> Tile
<input checked="" type="checkbox"/> Slab	<input checked="" type="checkbox"/> Carpet
<input checked="" type="checkbox"/> Sub & Joist	<input checked="" type="checkbox"/> Unfinished
<input checked="" type="checkbox"/> Wood	<input type="checkbox"/> Other
<input type="checkbox"/> Parquet	

Wall Finish

<input checked="" type="checkbox"/> Plaster/Drywall	<input checked="" type="checkbox"/> Unfinished
<input type="checkbox"/> Paneling	<input type="checkbox"/> Other
<input type="checkbox"/> Fiberboard	

Roofing

<input type="checkbox"/> Built-Up	<input type="checkbox"/> Metal	<input checked="" type="checkbox"/> Asphalt	<input type="checkbox"/> Slate	<input type="checkbox"/> Tile
<input type="checkbox"/> Wood Shingle	<input type="checkbox"/> Other			

Exterior Features

Description	Area	Value
Porch, Enclosed Frame	196	\$13,800
Patio, Concrete (Terraced)	234	\$2,700
Canopy, Roof Extension	126	\$1,900
Patio, Concrete	112	\$800

Plumbing

	#	TF
Full Bath	2	6
Half Bath	0	0
Kitchen Sinks	1	1
Water Heaters	1	1
Add Fixtures	0	0
Total	4	8

Accommodations

Bedrooms	3
Living Rooms	1
Dining Rooms	1
Family Rooms	0
Total Rooms	6

Heat Type

Central Warm Air

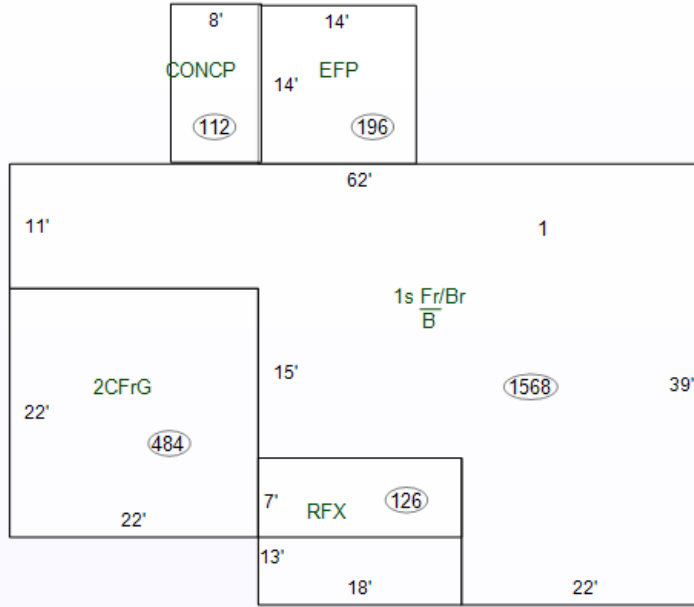

Specialty Plumbing

Description	Count	Value
-------------	-------	-------

Cost Ladder

Floor	Constr	Base	Finish	Value	Totals
1	91A	1568	1568	\$141,300	
2					
3					
4					
1/4					
1/2					
3/4					
Attic					
Bsmt		1568	0	\$46,500	
Crawl					
Slab					

Total Base \$187,800

Adjustments 1 Row Type Adj. x 1.00 \$187,800

Unfin Int (-)		\$0
Ex Liv Units (+)		\$0
Rec Room (+)		\$0
Loft (+)		\$0
Fireplace (+)	MS:1 MO:1	\$4,500
No Heating (-)		\$0
A/C (+)	1:1568	\$5,000
No Elec (-)		\$0
Plumbing (+ / -)	8 - 5 = 3 x \$800	\$2,400
Spec Plumb (+)		\$0
Elevator (+)		\$0

Sub-Total, One Unit \$199,700

Sub-Total, 1 Units

Exterior Features (+)	\$19,200	\$218,900
Garages (+) 484 sqft	\$20,100	\$239,000
Quality and Design Factor (Grade)		1.05
Location Multiplier		0.85

Replacement Cost \$213,308

Summary of Improvements

Description	Story Height	Constr Type	Grade	Year Built	Eff Year	Eff Co Age	nd	Base Rate	LCM	Adj Rate	Size	RCN	Norm Dep	Remain. Value	Abn Obs	PC	Nbhd	Mrkt	Cap 1	Cap 2	Cap 3	Improv Value
1: Residential Dwelling	1	1/6 Maso	C+1	1963	1973	52	A		0.85		3,136 sqft	\$213,308	40%	\$127,980	14%	100%	1.240	1.000	100.00	0.00	0.00	\$136,500