

General Information

Parcel Number 89-18-03-340-202.000-030
Local Parcel Number 50-03-340-202.000-29

Tax ID: 029-30448-02

Routing Number 5003340-058

Property Class 510
1 Family Dwell - Platted Lot

Year: 2025

Location Information

County WAYNE

Township WAYNE TOWNSHIP

District 030 (Local 029)
RICHMOND CITY -WAYNE TWP

School Corp 8385
RICHMOND COMMUNITY

Neighborhood 293353-029
WAYNE-293353 (029)

Section/Plat 5003340

Location Address (1)
718 FOREST HILLS BLVD
RICHMOND, IN 47374

Zoning

Subdivision

Lot

Market Model
N/A

Characteristics

Topography Level Flood Hazard

Public Utilities ERA
All

Streets or Roads TIF
Paved

Neighborhood Life Cycle Stage
Static

Printed Tuesday, April 29, 2025

Review Group 2027

Ownership

NICHOLAS, JAMES WILLIS JR
718 FOREST HILLS BLVD
RICHMOND, IN 47374

Legal

LOT 44 MEADOW PARK SEC 4



Transfer of Ownership

Table with columns: Date, Owner, Doc ID, Code, Book/Page, Adj Sale Price, V/I. Rows include transactions from 02/25/2013 to 01/01/1900.

Notes

12/6/2022 Misc: 2023 GENERAL REVALUATION

Valuation Records (Work In Progress values are not certified values and are subject to change)

Table with columns: Assessment Year, Reason For Change, As Of Date, Valuation Method, Equalization Factor, Notice Required, Land, Improvement, Total. Rows show data for years 2022-2025.

Land Data (Standard Depth: Res 132', CI 132' Base Lot: Res 100' X 132', CI 100' X 132')

Table with columns: Land Type, Pricing Method, Soil ID, Act Front, Size, Factor, Rate, Adj. Rate, Ext. Value, Infl. %, Market Factor, Cap 1, Cap 2, Cap 3, Value.

Land Computations

Table with columns: Computation Name, Value. Rows include Calculated Acreage (0.20), Actual Frontage (72), Developer Discount, Parcel Acreage (0.20), 81 Legal Drain NV (0.00), 82 Public Roads NV (0.00), 83 UT Towers NV (0.00), 9 Homesite (0.00), 91/92 Acres (0.00), Total Acres Farmland (0.20), Farmland Value (\$0), Measured Acreage (0.00), Avg Farmland Value/Acre (0.0), Value of Farmland (\$0), Classified Total (\$0), Farm / Classified Value (\$0), Homesite(s) Value (\$0), 91/92 Value (\$0), Supp. Page Land Value, CAP 1 Value (\$29,200), CAP 2 Value (\$0), CAP 3 Value (\$0), Total Value (\$29,200).

**General Information**

<b>Occupancy</b>	Single-Family
<b>Description</b>	Residential Dwelling
<b>Story Height</b>	2
<b>Style</b>	N/A
<b>Finished Area</b>	2023 sqft
<b>Make</b>	

**Floor Finish**

<input type="checkbox"/> Earth	<input checked="" type="checkbox"/> Tile
<input checked="" type="checkbox"/> Slab	<input checked="" type="checkbox"/> Carpet
<input checked="" type="checkbox"/> Sub & Joist	<input checked="" type="checkbox"/> Unfinished
<input type="checkbox"/> Wood	<input type="checkbox"/> Other
<input type="checkbox"/> Parquet	

**Wall Finish**

<input checked="" type="checkbox"/> Plaster/Drywall	<input checked="" type="checkbox"/> Unfinished
<input checked="" type="checkbox"/> Paneling	<input type="checkbox"/> Other
<input type="checkbox"/> Fiberboard	

**Roofing**

<input type="checkbox"/> Built-Up	<input type="checkbox"/> Metal	<input checked="" type="checkbox"/> Asphalt	<input type="checkbox"/> Slate	<input type="checkbox"/> Tile
<input type="checkbox"/> Wood Shingle	<input type="checkbox"/> Other			

**Exterior Features**

Description	Area	Value
Wood Deck	276	\$5,900
Porch, Open Frame	154	\$8,300

**Plumbing**

	#	TF
<b>Full Bath</b>	2	6
<b>Half Bath</b>	1	2
<b>Kitchen Sinks</b>	1	1
<b>Water Heaters</b>	1	1
<b>Add Fixtures</b>	0	0
<b>Total</b>	5	10

**Accommodations**

<b>Bedrooms</b>	4
<b>Living Rooms</b>	1
<b>Dining Rooms</b>	1
<b>Family Rooms</b>	1
<b>Total Rooms</b>	8

**Heat Type**

Central Warm Air

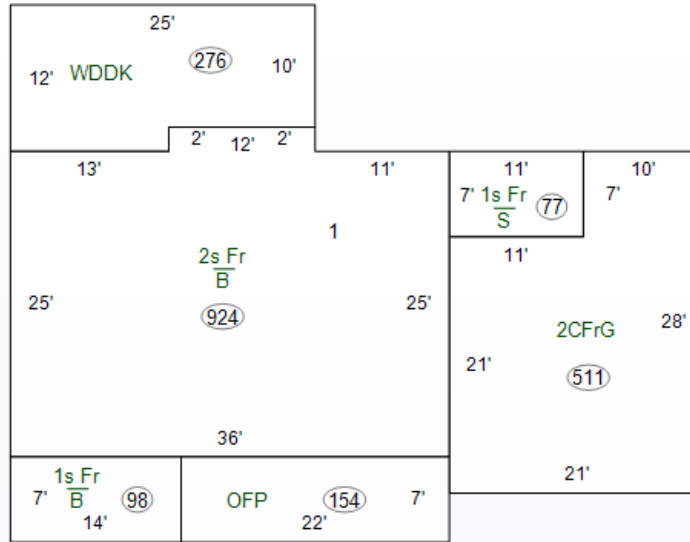

**Specialty Plumbing**

Description	Count	Value
-------------	-------	-------

**Cost Ladder**

Floor	Constr	Base	Finish	Value	Totals
1	1Fr	1099	1099	\$111,500	
2	1Fr	924	924	\$49,600	
3					
4					
1/4					
1/2					
3/4					
Attic					
Bsmt		1022	0	\$35,200	
Crawl					
Slab		77	0	\$0	

<b>Total Base</b>		\$196,300
<b>Adjustments</b>	<b>1 Row Type Adj. x 1.00</b>	\$196,300

Unfin Int (-)		\$0
Ex Liv Units (+)		\$0
Rec Room (+)	2:500	\$6,000
Loft (+)		\$0
Fireplace (+)	PS:1 PO:1	\$4,700
No Heating (-)		\$0
A/C (+)	1:1099 2:924	\$5,900
No Elec (-)		\$0
Plumbing (+ / -)	10 - 5 = 5 x \$800	\$4,000
Spec Plumb (+)		\$0
Elevator (+)		\$0

<b>Sub-Total, One Unit</b>	\$216,900
----------------------------	-----------

Sub-Total, 1 Units	
Exterior Features (+)	\$14,200 \$231,100
Garages (+) 511 sqft	\$20,100 \$251,200
Quality and Design Factor (Grade)	1.10
Location Multiplier	0.85
<b>Replacement Cost</b>	<b>\$234,872</b>

**Summary of Improvements**

Description	Story Height	Constr Type	Grade	Year Built	Eff Year	Eff Age	Co Age	nd	Base Rate	LCM	Adj Rate	Size	RCN	Norm Dep	Remain. Value	Abn Obs	PC	Nbhd	Mrkt	Cap 1	Cap 2	Cap 3	Improv Value
1: Residential Dwelling	2	Wood Fr	C+2	1990	1990	35	G			0.85		3,045 sqft	\$234,872	24%	\$178,500	0%	100%	1.300	1.000	100.00	0.00	0.00	\$232,100