

General Information

Parcel Number 89-18-04-310-113.000-030
Local Parcel Number 50-04-310-113.000-29

Tax ID: 029-40546-00

Routing Number 5004310-144

Property Class 510
1 Family Dwell - Platted Lot

Year: 2025

Location Information

County WAYNE

Township WAYNE TOWNSHIP

District 030 (Local 029)
RICHMOND CITY -WAYNE TWP

School Corp 8385
RICHMOND COMMUNITY

Neighborhood 296356-029
WAYNE-296356 (029)

Section/Plat 5004310

Location Address (1)
524 S 12TH ST
RICHMOND, IN 47374

Zoning ZO01 Residential

Subdivision

Lot

Market Model N/A

Characteristics

Topography High Flood Hazard

Public Utilities All ERA

Streets or Roads Paved TIF

Neighborhood Life Cycle Stage Static

Printed Tuesday, April 29, 2025

Review Group 2027

Ownership

GARCIA, LIBRADA L & JOSE JUAN C
524 S 12TH ST
RICHMOND, IN 47374

Legal

LOT 7 C & R



Transfer of Ownership

Table with columns: Date, Owner, Doc ID, Code, Book/Page, Adj Sale Price, V/I. Rows include transactions from 03/28/2023 to 01/01/1900.

Notes

6/16/2023 Appeal: 2023: INFORMAL REVIEW
12/16/2022 Misc: 2023 GENERAL REVALUATION

Valuation Records (Work In Progress values are not certified values and are subject to change)

Table with columns: Assessment Year, Reason For Change, As Of Date, Valuation Method, Equalization Factor, Notice Required, Land, Improvement, Total. Rows show valuation data for years 2025, 2024, and 2023.

Land Data (Standard Depth: Res 150', CI 150' Base Lot: Res 100' X 150', CI 100' X 150')

Table with columns: Land Type, Pricing Method, Soil ID, Act Front, Size, Factor, Rate, Adj. Rate, Ext. Value, Infl. %, Market Factor, Cap 1, Cap 2, Cap 3, Value.

Land Computations

Table with columns: Computation Name, Value. Rows include Calculated Acreage (0.16), Actual Frontage (43), Developer Discount, Parcel Acreage (0.16), 81 Legal Drain NV (0.00), 82 Public Roads NV (0.00), 83 UT Towers NV (0.00), 9 Homesite (0.00), 91/92 Acres (0.00), Total Acres Farmland (0.16), Farmland Value (\$0), Measured Acreage (0.00), Avg Farmland Value/Acre (0.0), Value of Farmland (\$0), Classified Total (\$0), Farm / Classified Value (\$0), Homesite(s) Value (\$0), 91/92 Value (\$0), Supp. Page Land Value, CAP 1 Value (\$4,600), CAP 2 Value (\$0), CAP 3 Value (\$0), Total Value (\$4,600).

General Information

Occupancy	Single-Family
Description	Residential Dwelling
Story Height	2
Style	N/A
Finished Area	1484 sqft
Make	

Floor Finish

<input type="checkbox"/> Earth	<input type="checkbox"/> Tile
<input checked="" type="checkbox"/> Slab	<input checked="" type="checkbox"/> Carpet
<input checked="" type="checkbox"/> Sub & Joist	<input checked="" type="checkbox"/> Unfinished
<input type="checkbox"/> Wood	<input type="checkbox"/> Other
<input type="checkbox"/> Parquet	

Wall Finish

<input checked="" type="checkbox"/> Plaster/Drywall	<input checked="" type="checkbox"/> Unfinished
<input type="checkbox"/> Paneling	<input type="checkbox"/> Other
<input type="checkbox"/> Fiberboard	

Roofing

<input type="checkbox"/> Built-Up	<input type="checkbox"/> Metal	<input checked="" type="checkbox"/> Asphalt	<input type="checkbox"/> Slate	<input type="checkbox"/> Tile
<input type="checkbox"/> Wood Shingle	<input type="checkbox"/> Other			

Exterior Features

Description	Area	Value
Porch, Open Frame	217	\$10,900

Plumbing

	#	TF
Full Bath	1	3
Half Bath	0	0
Kitchen Sinks	1	1
Water Heaters	1	1
Add Fixtures	0	0
Total	3	5

Accommodations

Bedrooms	4
Living Rooms	1
Dining Rooms	1
Family Rooms	0
Total Rooms	7

Heat Type

Central Warm Air

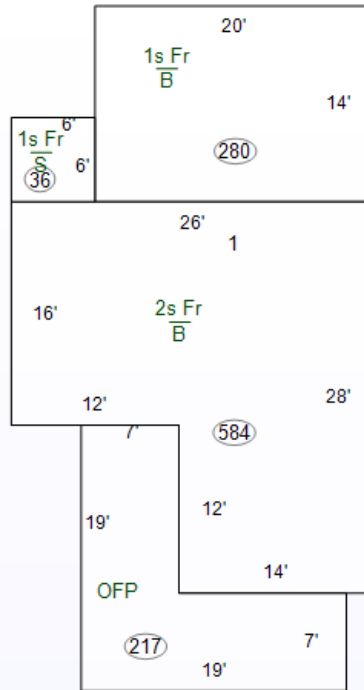

Specialty Plumbing

Description	Count	Value
-------------	-------	-------

Cost Ladder

Floor	Constr	Base	Finish	Value	Totals
1	1Fr	900	900	\$96,900	
2	1Fr	584	584	\$38,200	
3					
4					
1/4					
1/2					
3/4					
Attic					
Bsmt		864	0	\$32,100	
Crawl					
Slab		36	0	\$0	

Total Base \$167,200

Adjustments 1 Row Type Adj. x 1.00 \$167,200

Unfin Int (-)	\$0
Ex Liv Units (+)	\$0
Rec Room (+)	\$0
Loft (+)	\$0
Fireplace (+)	\$0
No Heating (-)	\$0
A/C (+)	\$0
No Elec (-)	\$0
Plumbing (+ / -)	5 - 5 = 0 x \$0 \$0
Spec Plumb (+)	\$0
Elevator (+)	\$0

Sub-Total, One Unit \$167,200

Sub-Total, 1 Units

Exterior Features (+)	\$10,900	\$178,100
Garages (+) 0 sqft	\$0	\$178,100
Quality and Design Factor (Grade)		0.85
Location Multiplier		0.85

Replacement Cost \$128,677

Summary of Improvements

Description	Story Height	Constr Type	Grade	Year Built	Eff Year	Eff Co Age nd	Base Rate	LCM	Adj Rate	Size	RCN	Norm Dep	Remain. Value	Abn Obs	PC	Nbhd	Mrkt	Cap 1	Cap 2	Cap 3	Improv Value
1: Residential Dwelling	2	Wood Fr	D+1	1900	1900	125 A		0.85		2,348 sqft	\$128,677	50%	\$64,340	15%	100%	0.850	1.000	100.00	0.00	0.00	\$46,500