

89-18-09-130-612.000-030

KIDDER, PAMELA

1513 S 11TH ST

510, 1 Family Dwell - Platted Lot

WAYNE-295435 (029)/2954

1/2

General Information

Parcel Number 89-18-09-130-612.000-030
Local Parcel Number 50-09-130-612.000-29

Tax ID: 029-40354-00

Routing Number

Property Class 510
1 Family Dwell - Platted Lot

Year: 2025

Location Information

County WAYNE
Township WAYNE TOWNSHIP
District 030 (Local 029) RICHMOND CITY -WAYNE TWP
School Corp 8385 RICHMOND COMMUNITY
Neighborhood 295435-029 WAYNE-295435 (029)
Section/Plat 5009130
Location Address (1) 1513 S 11TH ST RICHMOND, IN 47374

Ownership

KIDDER, PAMELA
1513 S 11TH ST
RICHMOND, IN 47374

Legal

LOT 5 HIBBERD TERRACE ADDN

Transfer of Ownership

Table with columns: Date, Owner, Doc ID, Code, Book/Page, Adj Sale Price, V/I. Rows include transactions from 08/16/2021 to 01/01/1900.

Notes

11/7/2022 Misc: 2023 GENERAL REVALUATION



Res

Valuation Records (Work In Progress values are not certified values and are subject to change)

Table with columns: Year, Assessment Year, Reason For Change, As Of Date, Valuation Method, Equalization Factor, Notice Required, Land, Land Res (1-3), Improvement, Imp Res (1-3), Total, Total Res (1-3).

Land Computations

Table with columns: Description, Value. Rows include Calculated Acreage, Actual Frontage, Developer Discount, Parcel Acreage, 81 Legal Drain NV, 82 Public Roads NV, 83 UT Towers NV, 9 Homesite, 91/92 Acres, Total Acres Farmland, Farmland Value, Measured Acreage, Avg Farmland Value/Acre, Value of Farmland, Classified Total, Farm / Classified Value, Homesite(s) Value, 91/92 Value, Supp. Page Land Value, CAP 1 Value, CAP 2 Value, CAP 3 Value, Total Value.

Zoning

Subdivision

Lot

Market Model N/A

Characteristics

Topography Level Flood Hazard
Public Utilities ERA
Streets or Roads TIF
Paved

Neighborhood Life Cycle Stage Static

Printed Wednesday, April 30, 2025

Review Group 2027

Data Source External Only

Collector 10/20/2022 jh

Appraiser 11/07/2022 Nexus

General Information

Occupancy Single-Family
Description Residential Dwelling
Story Height 1
Style N/A
Finished Area 672 sqft
Make

Floor Finish

- Earth Tile
- Slab Carpet
- Sub & Joist Unfinished
- Wood Other
- Parquet

Wall Finish

- Plaster/Drywall Unfinished
- Paneling Other
- Fiberboard

Roofing

- Built-Up Metal Asphalt Slate Tile
- Wood Shingle Other

Exterior Features

Description	Area	Value
Patio, Concrete	48	\$400
Patio, Concrete	80	\$600
Canopy, Roof Extension	80	\$1,300

Plumbing

	#	TF
Full Bath	1	3
Half Bath	0	0
Kitchen Sinks	1	1
Water Heaters	1	1
Add Fixtures	0	0
Total	3	5

Accommodations

Bedrooms	2
Living Rooms	1
Dining Rooms	0
Family Rooms	0
Total Rooms	4

Heat Type

Central Warm Air

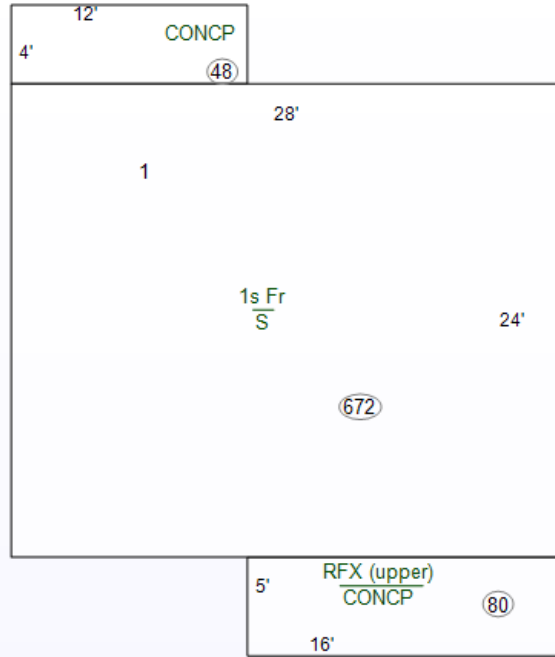

Specialty Plumbing		
Description	Count	Value

Cost Ladder

Floor Constr	Base	Finish	Value	Totals
1 1Fr	672	672	\$78,600	
2				
3				
4				
1/4				
1/2				
3/4				
Attic				
Bsmt				
Crawl				
Slab	672	0	\$0	
			Total Base	\$78,600

Adjustments	1 Row Type Adj. x 1.00	Totals
Unfin Int (-)		\$0
Ex Liv Units (+)		\$0
Rec Room (+)		\$0
Loft (+)		\$0
Fireplace (+)		\$0
No Heating (-)		\$0
A/C (+)		\$0
No Elec (-)		\$0
Plumbing (+ / -)	5 - 5 = 0 x \$0	\$0
Spec Plumb (+)		\$0
Elevator (+)		\$0

Sub-Total, One Unit			\$78,600
Sub-Total, 1 Units			
Exterior Features (+)	\$2,300		\$80,900
Garages (+) 0 sqft	\$0		\$80,900
Quality and Design Factor (Grade)			0.80
Location Multiplier			0.85
Replacement Cost			\$55,012

Summary of Improvements

Description	Story Height	Constr Type	Grade	Year Built	Eff Year	Eff Co Age	nd	Base Rate	LCM	Adj Rate	Size	RCN	Norm Dep	Remain. Value	Abn Obs	PC	Nbhd	Mrkt	Cap 1	Cap 2	Cap 3	Improv Value
1: Residential Dwelling	1	Wood Fr	D	1948	1995	30	A		0.85		672 sqft	\$55,012	28%	\$39,610	0%	100%	0.980	1.000	100.00	0.00	0.00	\$38,800