

89-18-09-130-617.000-030

SHAPIRO, KATHERINE 2022 FA

1533 S 11TH ST

510, 1 Family Dwell - Platted Lot

WAYNE-295435 (029)/2954

1/2

General Information

Parcel Number 89-18-09-130-617.000-030
Local Parcel Number 50-09-130-617.000-29

Tax ID: 029-10175-00

Routing Number

Property Class 510 RENTAL
1 Family Dwell - Platted Lot

Year: 2025

Location Information

County WAYNE

Township WAYNE TOWNSHIP

District 030 (Local 029) RICHMOND CITY -WAYNE TWP

School Corp 8385 RICHMOND COMMUNITY

Neighborhood 295435-029 WAYNE-295435 (029)

Section/Plat 5009130

Location Address (1) 1533 S 11TH ST RICHMOND, IN 47374

Zoning

Subdivision

Lot

Market Model N/A

Characteristics

Topography Level Flood Hazard

Public Utilities All ERA

Streets or Roads Paved TIF

Neighborhood Life Cycle Stage Static

Printed Wednesday, April 30, 2025

Review Group 2027

Ownership

SHAPIRO, KATHERINE 2022 FAMILY
3 QUARTERHORSE LN
ROLLING HILLS ESTATES, CA 90274

Legal

PT LOTS 9 & 10 HIBBERD TERRACE REPLAT

Transfer of Ownership

Table with columns: Date, Owner, Doc ID, Code, Book/Page, Adj Sale Price, V/I. Rows include transactions from 10/10/2023 to 04/08/2011.

Notes

11/7/2022 Misc: 2023 GENERAL REVALUATION



Res

Valuation Records (Work In Progress values are not certified values and are subject to change)

Table with columns: Assessment Year, Reason For Change, As Of Date, Valuation Method, Equalization Factor, Notice Required, Land, Improvement, Total. Rows show values for years 2022-2025.

Land Data (Standard Depth: Res 150', CI 150' Base Lot: Res 100' X 150', CI 100' X 150')

Table with columns: Land Type, Pricing Method, Soil ID, Act Front, Size, Factor, Rate, Adj. Rate, Ext. Value, Infl. %, Market Factor, Cap 1, Cap 2, Cap 3, Value.

Land Computations

Table with columns: Computation Name, Value. Rows include Calculated Acreage, Actual Frontage, Developer Discount, Parcel Acreage, 81 Legal Drain NV, 82 Public Roads NV, 83 UT Towers NV, 9 Homesite, 91/92 Acres, Total Acres Farmland, Farmland Value, Measured Acreage, Avg Farmland Value/Acre, Value of Farmland, Classified Total, Farm / Classified Value, Homesite(s) Value, 91/92 Value, Supp. Page Land Value, CAP 1 Value, CAP 2 Value, CAP 3 Value, Total Value.

Data Source External Only

Collector 10/20/2022 jh

Appraiser 11/07/2022 Nexus

Total Value \$10,000

**General Information**

<b>Occupancy</b>	Single-Family
<b>Description</b>	Residential Dwelling
<b>Story Height</b>	1
<b>Style</b>	N/A
<b>Finished Area</b>	1472 sqft
<b>Make</b>	

**Floor Finish**

<input type="checkbox"/> Earth	<input type="checkbox"/> Tile
<input checked="" type="checkbox"/> Slab	<input checked="" type="checkbox"/> Carpet
<input type="checkbox"/> Sub & Joist	<input type="checkbox"/> Unfinished
<input type="checkbox"/> Wood	<input type="checkbox"/> Other
<input type="checkbox"/> Parquet	

**Wall Finish**

<input checked="" type="checkbox"/> Plaster/Drywall	<input type="checkbox"/> Unfinished
<input type="checkbox"/> Paneling	<input type="checkbox"/> Other
<input type="checkbox"/> Fiberboard	

**Roofing**

<input type="checkbox"/> Built-Up	<input type="checkbox"/> Metal	<input checked="" type="checkbox"/> Asphalt	<input type="checkbox"/> Slate	<input type="checkbox"/> Tile
<input type="checkbox"/> Wood Shingle		<input type="checkbox"/> Other		

**Exterior Features**

Description	Area	Value
Porch, Open Frame	96	\$6,300

**Plumbing**

	#	TF
<b>Full Bath</b>	1	3
<b>Half Bath</b>	1	2
<b>Kitchen Sinks</b>	1	1
<b>Water Heaters</b>	1	1
<b>Add Fixtures</b>	0	0
<b>Total</b>	4	7

**Accommodations**

<b>Bedrooms</b>	3
<b>Living Rooms</b>	1
<b>Dining Rooms</b>	1
<b>Family Rooms</b>	0
<b>Total Rooms</b>	6

**Heat Type**

Central Warm Air

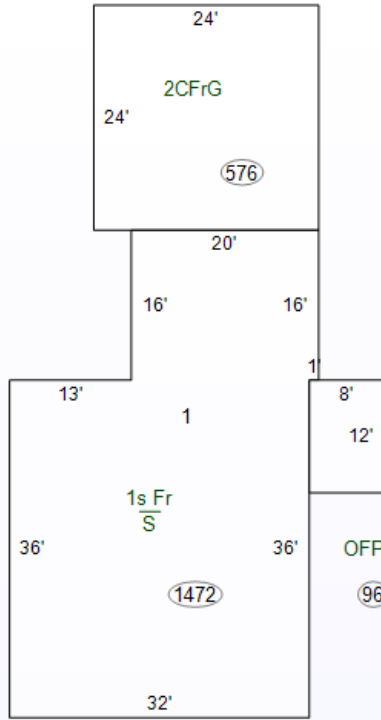

**Specialty Plumbing**

Description	Count	Value
-------------	-------	-------

**Cost Ladder**

Floor	Constr	Base	Finish	Value	Totals
1	1Fr	1472	1472	\$133,200	
2					
3					
4					
1/4					
1/2					
3/4					
Attic					
Bsmt					
Crawl					
Slab		1472	0	\$0	

**Total Base** \$133,200

**Adjustments** 1 Row Type Adj. x 1.00 \$133,200

Unfin Int (-)		\$0
Ex Liv Units (+)		\$0
Rec Room (+)		\$0
Loft (+)		\$0
Fireplace (+)	MS:1 MO:1	\$4,500
No Heating (-)		\$0
A/C (+)		\$0
No Elec (-)		\$0
Plumbing (+ / -)	7 - 5 = 2 x \$800	\$1,600
Spec Plumb (+)		\$0
Elevator (+)		\$0

**Sub-Total, One Unit** \$139,300

**Sub-Total, 1 Units**

Exterior Features (+)	\$6,300	\$145,600
Garages (+) 576 sqft	\$24,700	\$170,300
Quality and Design Factor (Grade)		0.80
Location Multiplier		0.85
<b>Replacement Cost</b>		<b>\$115,804</b>

**Summary of Improvements**

Description	Story Height	Constr Type	Grade	Year Built	Eff Year	Eff Co Age	nd	Base Rate	LCM	Adj Rate	Size	RCN	Norm Dep	Remain. Value	Abn Obs	PC	Nbhd	Mrkt	Cap 1	Cap 2	Cap 3	Improv Value
1: Residential Dwelling	1	Wood Fr	D	1951	1951	74	A		0.85		1,472 sqft	\$115,804	50%	\$57,900	0%	100%	0.980	1.000	100.00	0.00	0.00	\$56,700