

89-18-09-320-132.000-030

EVANS, GREGORY ALLEN

1506 S T ST

510, 1 Family Dwell - Platted Lot

WAYNE-295435 (029)/2954

1/2

General Information

Parcel Number 89-18-09-320-132.000-030
Local Parcel Number 50-09-320-132.000-29

Tax ID: 029-02722-00

Routing Number 5009320-023

Property Class 510
1 Family Dwell - Platted Lot

Year: 2025

Location Information

County WAYNE

Township WAYNE TOWNSHIP

District 030 (Local 029)
RICHMOND CITY -WAYNE TWP

School Corp 8385
RICHMOND COMMUNITY

Neighborhood 295435-029
WAYNE-295435 (029)

Section/Plat 5009320

Location Address (1)
1506 S T ST
RICHMOND, IN 47374

Zoning

Subdivision

Lot

Market Model
N/A

Characteristics

Topography Level Flood Hazard

Public Utilities All ERA

Streets or Roads Paved TIF

Neighborhood Life Cycle Stage
Static

Printed Wednesday, April 30, 2025

Review Group 2027

Ownership

EVANS, GREGORY ALLEN
1506 S T ST
RICHMOND, IN 47374

Legal

LOTS 21 & 22 SHARRON-ANN ADDN



Transfer of Ownership

Date 01/01/1900 Owner EVANS, GREGORY A Doc ID Code Book/Page Adj Sale Price V/I

Notes

11/2/2022 Misc: 2023 GENERAL REVALUATION

Valuation Records (Work In Progress values are not certified values and are subject to change)

Table with columns for Assessment Year (2022-2025), Reason For Change, As Of Date, Valuation Method, Equalization Factor, Notice Required, and Land/Improvement values.

Land Data (Standard Depth: Res 150', CI 150' Base Lot: Res 100' X 150', CI 100' X 150')

Table with columns for Land Type, Pricing Method, Soil ID, Act Front, Size, Factor, Rate, Adj. Rate, Ext. Value, Infl. %, Market Factor, Cap 1, Cap 2, Cap 3, and Value.

Land Computations

Table listing land computations such as Calculated Acreage, Actual Frontage, Developer Discount, Parcel Acreage, and Total Value.

Data Source External Only

Collector 10/20/2022 jh

Appraiser 11/02/2022 Nexus

Total Value \$22,100

**General Information**

**Occupancy** Single-Family  
**Description** Residential Dwelling  
**Story Height** 1  
**Style** N/A  
**Finished Area** 1112 sqft  
**Make**

**Floor Finish**

Earth  Tile  
 Slab  Carpet  
 Sub & Joist  Unfinished  
 Wood  Other  
 Parquet

**Wall Finish**

Plaster/Drywall  Unfinished  
 Paneling  Other  
 Fiberboard

**Roofing**

Built-Up  Metal  Asphalt  Slate  Tile  
 Wood Shingle  Other

**Exterior Features**

Description	Area	Value
Porch, Open Frame	204	\$10,100
Wood Deck	192	\$4,600

**Plumbing**

	#	TF
<b>Full Bath</b>	1	3
<b>Half Bath</b>	0	0
<b>Kitchen Sinks</b>	1	1
<b>Water Heaters</b>	1	1
<b>Add Fixtures</b>	0	0
<b>Total</b>	3	5

**Accommodations**

<b>Bedrooms</b>	2
<b>Living Rooms</b>	1
<b>Dining Rooms</b>	1
<b>Family Rooms</b>	1
<b>Total Rooms</b>	7

**Heat Type**

Central Warm Air

2 ●

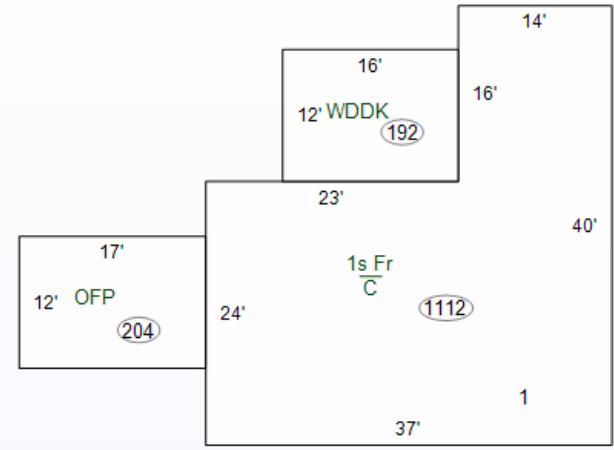

**Specialty Plumbing**

Description	Count	Value
-------------	-------	-------

**Cost Ladder**

Floor Constr	Base	Finish	Value	Totals
1 1Fr	1112	1112	\$111,500	
2				
3				
4				
1/4				
1/2				
3/4				
Attic				
Bsmt				
Crawl	1112	0	\$8,000	
Slab				

**Total Base** \$119,500

**Adjustments** 1 Row Type Adj. x 1.00 \$119,500

Unfin Int (-)		\$0
Ex Liv Units (+)		\$0
Rec Room (+)		\$0
Loft (+)		\$0
Fireplace (+)		\$0
No Heating (-)		\$0
A/C (+)	1:1112	\$4,000
No Elec (-)		\$0
Plumbing (+ / -)	5 - 5 = 0 x \$0	\$0
Spec Plumb (+)		\$0
Elevator (+)		\$0

**Sub-Total, One Unit** \$123,500

**Sub-Total, 1 Units**

Exterior Features (+) \$14,700 \$138,200

Garages (+) 0 sqft \$0 \$138,200

Quality and Design Factor (Grade) 0.95

Location Multiplier 0.85

**Replacement Cost** \$111,597

**Summary of Improvements**

Description	Story Height	Constr Type	Grade	Year Built	Eff Year	Eff Co Age	nd	Base Rate	LCM	Adj Rate	Size	RCN	Norm Dep	Remain. Value	Abn Obs	PC	Nbhd	Mrkt	Cap 1	Cap 2	Cap 3	Improv Value
1: Residential Dwelling	1	Wood Fr	C-1	1960	1960	65	G		0.85		1,112 sqft	\$111,597	37%	\$70,310	0%	100%	0.980	1.000	100.00	0.00	0.00	\$68,900
2: Detached Garage/Boat H	1	Wood Fr	C	1991	1991	34	A	\$38.62	0.85	\$32.83	24'x32'	\$25,211	26%	\$18,660	0%	100%	0.980	1.000	100.00	0.00	0.00	\$18,300